

Table of Contents

Introduction	2
Safety instructions and important notes	3
Description	6
Preparing for sterilisation.	8
Operation	8
Cleaning the appliance and removal of limescale deposits	10
Technical specifications	10
Explanation of symbols used on the product, its accessories and packaging	11
Instructions and information about the handling of the used packaging and product	11

Introduction

- The Bayby BBS 3030 Digital Steam Steriliser with Dryer features a large capacity, sterilises 6 baby bottles of all types including accessories at the same time.
- The drying function enables the removal of condensated water from the sterilised bottles and accessories.
- Adjustable operating mode: Automatic / Sterilisation / Drying. You can select between the Automatic sterilisation and drying mode or the only Sterilisation or the only Drying mode.
- The LCD display is microchip-controlled and provides information about the processes being performed. Simple operation.
- An audio signal indicates the end of the process and the appliance then turns off automatically.
- The bottle and accessory stand can also be used as a separate drip tray.

Safety instructions and important notes

- Only use the steriliser in accordance with the instructions included in this user's manual. Not adhering to these instructions may result in the incorrect operation of the steriliser or its damage. Keep this user's manual for future use.
- Never submerge the base unit, power cord or power plug in water or in any other liquid.
- The appliance may be used by children up to 8 years of age and persons with limited physical, sensory or mental abilities or by persons with insufficient experience and knowledge only when under supervision or after they have been instructed about the safe use of the appliance and when they are aware of all risks associated with using the appliance. Cleaning and user maintenance must not be performed by children younger than 8 years of age and that are unsupervised. Children must not play with the steriliser.
- Clean the steriliser according to the instructions contained in chapter Cleaning the appliance and removal of limescale deposits.
- In the event that limescale deposits are not removed according to the user's manual, permanent damage may result.
- Do not preheat the appliance.
- Keep the appliance and the power cord out of children's reach.
- Before connecting the appliance to the power grid, check that the voltage specified on the appliance corresponds to the voltage in the local power grid.
- If you discover a defect on the power plug, power cord or on the appliance, stop using it.
- In the event that the power cord is damaged, it must be replaced by an authorised service centre to prevent potential hazards.
- Do not attempt to open the electric steam steriliser yourself nor perform maintenance or repairs on it.
- The appliance heats up to a high temperature during the sterilisation process and may cause burns.

- Be careful of the hot steam escaping from the openings in the lid and also of the steam released when the lid is removed.
- Steam may cause burns.
- Do not touch the base unit, handles or the lid during the sterilisation process or shortly after it because these parts are very hot. Only lift the lid by the handle.
- Never move the appliance or open it while it is running or the water inside it is still hot.
- Do not place any items on to the appliance while it is in operation.
- Only use water free of additional agents.
- Do not put bleach or other chemicals into the appliance.
- Only sterilise bottles and accessories suitable for sterilisation. Before sterilisation, carefully study the manuals of the respective items and check that they are suitable for sterilisation. Do not sterilise items that are filled with water, for example pieces for teething with cooling fluid.
- The appliance is intended exclusively for indoor use.

**Attention:**

Never use any accessories or parts from other manufacturers. The use of such parts or accessories shall void the warranty.

- Do not subject the appliance to extreme heat or direct sunlight.
- Allow the appliance to fully cool down before storing or moving it.
- When the appliance is turned on, do not place items directly on to the heating element.
- Do not use the appliance if it has fallen or if you discover any type of damage. Entrust repairs to an authorised service centre.
- Always place and use the appliance on a dry, stable, level and horizontal surface.
- Do not place the appliance on a hot surface.
- Do not leave the power cord hanging over the edge of a table or countertop on which it is placed.

- After you have finished using the appliance and it has cooled down, always pour out the water that remains inside.
- Always disconnect the appliance when you have finished using it.
- Maintain an interval of 30 minutes between the individual functions of the steriliser and ensure that the appliance has cooled down before starting to use another function.
- After using the steriliser, wait at least 5 minutes for it to cool down before taking off its lid **A①**.

Description

Description of the product

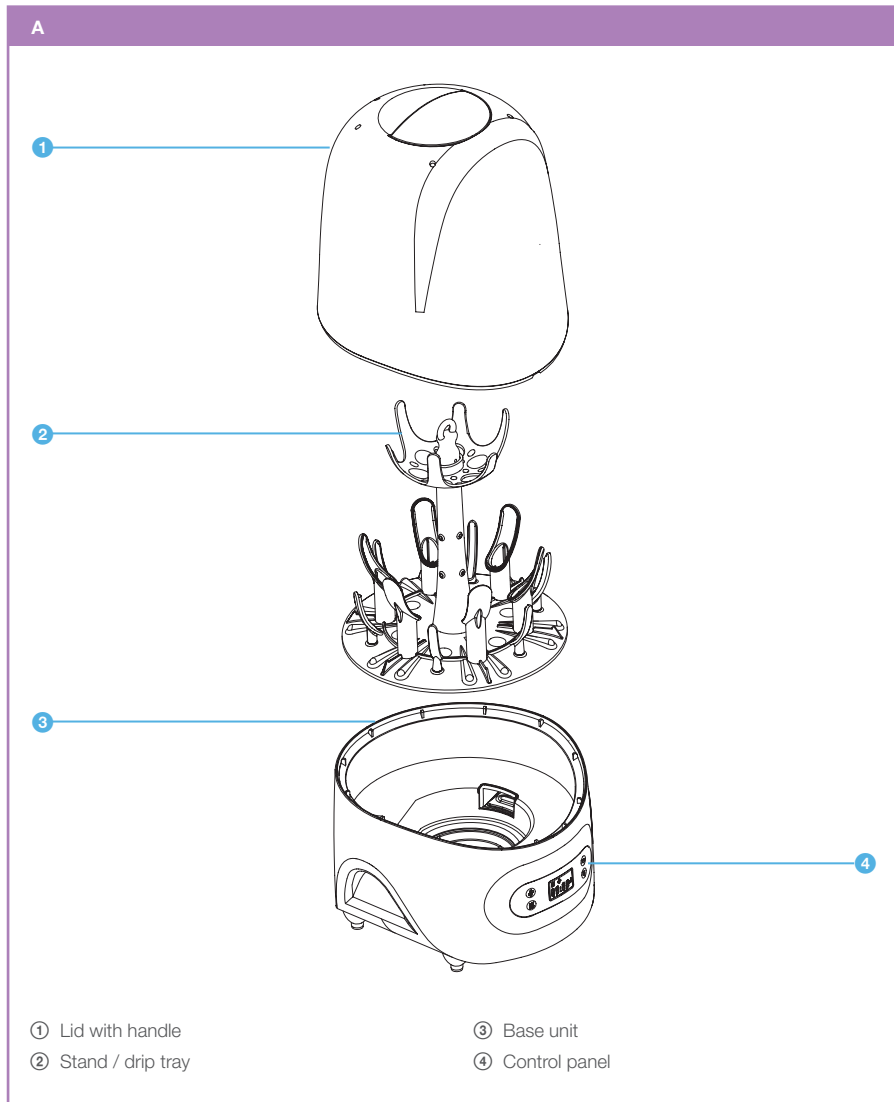

All parts, except for the stainless steel heating plate, are made from a material that does not contain BPA (Bisphenol A).

Description of the control panel

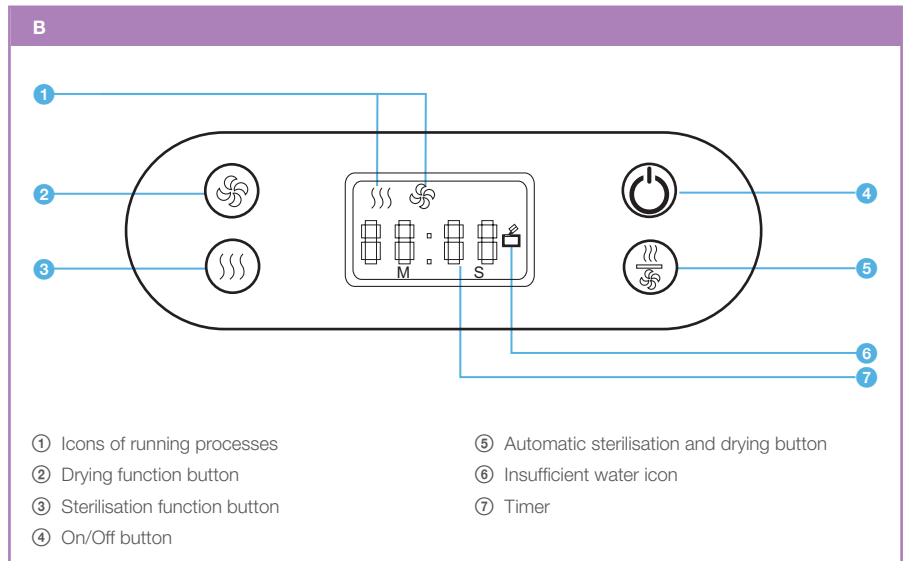

Preparing for sterilisation

- Before sterilising bottles and accessories, thoroughly wash them with a bottle brush and accessories in hot water using a detergent suitable for children, rinse thoroughly and allow to dry.

Assembling the steriliser

- Stand the steriliser on a horizontal and stable surface.
- Take off the lid of the steriliser **A①** and take the stand **A②** out of the base **A③** of the appliance.
- Using the measuring cup or, for example, a baby bottle, measure out exactly 120 ml of tap water and pour it directly on to the stainless steel heating plate inside the appliance. The water level should never rise over the line marked as "MAX 120ml" located inside the base of the steriliser **A③** above the stainless steel heating plate.
- Place the stand **A②** into the base **A③**.
- Place the baby bottles and accessories such as nipples, dust caps, screw rings, etc. on to the holders in the stand facing downwards so that they do not fill up with water, with the baby bottles in the lower position in the stand **A②** and the accessories in the upper position of the stand **A②**.

Note:

Make sure that all parts intended for sterilisation have been completely disassembled.

- Place the lid **A①** on to the base of the steriliser **A③** so that the arrow on the lid points at the arrow on the base of the steriliser **A③**. Make sure that the lid **A①** has properly adhered to the base **A③**. Never turn on the steriliser without putting on the lid with handle **A①**.
- Insert the power plug into a power socket.
- Now the appliance is ready for operation.
- Press the On/Off button **B④** on the control panel **A④** of the appliance. The LCD display will show the initial value 00:00. Select the desired function as described in Chapter Operation below. If you do not select any function after pressing the On/Off button **B④**, the appliance will automatically turn off after approximately 1 minute.

Operation



Attention:

Never use the appliance without water inside the steriliser!

- The steam that is released during the sterilisation process is hot. Keep your hands away from the appliance during the sterilisation process.

Automatic sterilisation and drying

- Assemble the steriliser according to the instructions included in chapter Assembling the steriliser.
- After pressing the On/Off button **B④**, select the Automatic sterilisation and drying function **B⑤** on the control panel **A④** of the appliance. For 45 minutes of drying after the sterilisation process, press the Automatic sterilisation and drying function **B⑤** once, for 60 minutes of drying press the button twice and for 30 minutes of drying press it three times.
- The automatic sterilisation and drying will commence 3 seconds after the last time the button is pressed.
- When the sterilisation process begins, the LCD display will show the approx. 11-minute countdown of the sterilisation cycle.
- The end of sterilisation is indicated by a sound signal. Then a 3-second pause follows and the automatic drying function will start and will run for the length of time set by pressing the Automatic sterilisation and drying button **B⑤** as described above. The timer **B⑦** on the LCD display will show the countdown in seconds until the initial value of 00:00 is reached.

- The appliance will indicate the end of the drying function with a sound signal and will turn off automatically.
- Wait until the appliance cools down. Only then take off the lid using handle A①.
- Be careful, steam may come out of the steriliser.
- When removing items out of the appliance, be very careful because they may still be hot.

Note:

Thoroughly wash your hands before touching any sterilised items.

- Disconnect the appliance from the socket and wait until it cools down completely.
- Pour out all remaining water from the base A③ and wipe it dry.

**Attention:**

The sterilisation time is approximately 11 minutes. If you pour less than 120 ml into the appliance, as is described in chapter Assembling the steriliser or if the water boils out sooner than 11 minutes, the device will inform the user with a sound signal that the sterilisation time has been insufficient for proper sterilisation. At the same time, the LCD display will turn red, show a insufficient water icon B⑥ and the sterilisation process will be stopped. The device will turn itself off automatically if there is no reaction within 2 hours.

Sterilisation

- Assemble the steriliser according to the instructions included in chapter Assembling the steriliser.
- After pressing the On/Off button B⑤ on the control panel A④, select the sterilisation function B③.
- The LCD display will show the initial value 00:00 and the sterilisation mode symbol.
- The sterilisation will start 3 seconds after the sterilisation button B③ is pressed.
- The LCD display will show the approx. 11-minute countdown of the sterilisation cycle
- The appliance will indicate the end of sterilisation with a sound signal and will turn off automatically.
- Wait until the appliance cools down. Only then take off the lid using handle A①.
- Be careful, steam may come out of the steriliser.
- When removing items out of the appliance, be very careful because they may still be hot.

Note:

Thoroughly wash your hands before touching any sterilised items.

- Disconnect the appliance from the socket and wait until it cools down completely.
- Pour out all remaining water from the base A③ and wipe it dry.

Drying

- Assemble the steriliser according to the instructions included in chapter Assembling the steriliser.
- After pressing the On/Off button B⑤ on the control panel A④, select the drying function B②.
- For 30 minutes of drying, press the drying function B② once, for 45 minutes of drying press the button twice and for 60 minutes of drying press it three times.
- The drying will start 3 seconds after the drying button B① is pressed for the last time.
- The timer B⑦ on the LCD display will show the countdown in seconds until the initial value of 00:00 is reached.
- The appliance will indicate the end of the drying function with a sound signal and will turn off automatically.
- Wait until the appliance cools down. Only then take off the lid using handle A①.
- Be careful, steam may come out of the steriliser.
- When removing items out of the appliance, be very careful because they may still be hot.

Note:

Thoroughly wash your hands before touching any sterilised items.

- Disconnect the appliance from the socket and wait until it cools down completely.
- Pour out any remaining water from the base A③ and wipe it dry.

Cleaning the appliance and removal of limescale deposits

Cleaning

- After every use, disconnect the steriliser from the power socket and allow it to cool down.
- For hygiene reasons, pour out any remaining water from the base A③.
- Clean the outer and inner side of the steriliser base A③ using a damp cloth.

**Attention:**

Do not clean the steriliser, its parts or its accessories using abrasive products, chemical solvents, cleaning products, alcohol, sharp utensils or steel wool.

**Attention:**

Never place the steriliser directly under running water or submerge the appliance or its parts and accessories in water or other liquids!

- Never wash the steriliser in a dishwasher! The lid A③ and stand A② can be washed in warm water with kitchen detergent.
- After cleaning it, store the steriliser in a clean dry location.

Removing limescale deposits

- When using the steriliser, small stains may appear on the heating element in the base A③. These are accumulated limescale deposits. The harder the water, the faster limescale deposits will form.
- Disconnect the steriliser from the power socket and allow it to cool down.
- It is recommended to remove limescale deposits from the appliance every 4 weeks to ensure further effective operation of the appliance.
- Mix 15 ml of white vinegar with 15 ml of hot water and pour this solution into the bottle warmer. Allow this solution to act for approximately 30 minutes in the steriliser base A③ and then pour it out.
- Never turn on the appliance while the water and vinegar solution is in the steriliser base A③.
- After emptying out the steriliser, repeatedly clean the outer and inner side of the bottle warmer using a cloth. In the event that despite this limescale deposits continue to appear, repeat the limescale removal procedure.

Technical specifications

Model number	BBS 3030
Voltage and power input of the appliance	220–240 V ~ 50 Hz, 600 W
Protection class against injury by electrical shock	Protection class I.
Operating conditions	Ambient temperature: 7 °C to 37 °C

Explanation of symbols used on the product, its accessories and packaging



This symbol indicates "Important notice".



This symbol indicates that prior to using the product, the user should read the user's manual.



This symbol indicates that this appliance meets all the basic requirements of EU directives related to it.



This symbol serves to designate the production lot number.



This symbol indicates that a fee has been paid to an organisation performing recollection and utilisation of the packaging waste.



This symbol indicates the material from which the packaging is made.



This symbol on products or original documents means that used electric or electronic products must not be added to ordinary municipal waste. For proper disposal, renewal and recycling hand over these appliances to determined collection points. Alternatively, in some European Union states or other European countries you may return your appliances to the local retailer when buying an equivalent new appliance. Correct disposal of this product helps save valuable natural resources and prevents potential negative effects on the environment and human health, which could result from improper waste disposal. Ask your local authorities or collection facility for more details. In accordance with national regulations penalties may be imposed for the incorrect disposal of this type of waste.

For business entities in European Union states

If you want to dispose of electric or electronic appliances, ask your retailer or supplier for the necessary information.

Disposal in other countries outside the European Union.

This symbol is valid in the European Union. If you wish to dispose of this product, request the necessary information about the correct disposal method from the local council or from your retailer.

Instructions and information about the handling of the used packaging and product

Dispose of used packaging material at a site designated for waste in your municipality.

At the end of its service life, do not throw the appliance out with ordinary municipal waste, rather take it to a recycling facility. In this way you will help protect the environment.

The Czech language is the original version of the user's manual. Changes to text and technical parameters are reserved.