



BBM 7000

EN / Digital Audio Baby Monitor ■ User's manual

CZ / Digitální audio chůvička ■ Návod k obsluze

SK / Digitálna audio opatrovatel'ka ■ Návod na obsluhu

HU / Digitális audió babaőrző ■ Használati útmutató



EN

3

CZ

19

SK

35

HU

51



Table of Contents

Introduction	4
Safety instructions and important notes	4
Description of the accessories	6
Description of the baby unit	7
Description of the parent unit	8
Installation location of the baby unit and parent unit	9
Power source	9
Using the baby monitor	11
General information about using the baby monitor	12
ECO mode	12
Troubleshooting	13
Cleaning and maintenance	14
Technical specifications	14
Explanation of symbols used on the product, its accessories and packaging	15
Instructions and information about the handling of used packaging	16
Warranty conditions	17

Introduction

- Thank you for selecting the Bayby BBM 7000 Digital Audio Baby Monitor. This digital baby monitor is a great child care accessory that enables you to hear your baby when you are not in the same room. Nevertheless, it is important to understand that it cannot serve as a substitute for responsible adult supervision.
- The sound detected by the baby unit is transmitted to the parent unit. DECT digital wireless technology is utilised for transmitting the audio signal. This guarantees very high quality audio transmission up to a range of 300 metres.
- The encrypted wireless transmission and automatic free channel selection features guarantee privacy and the peace of mind that you will hear only your child.
- You will be informed about an exceeded signal range, loss of signal or interference by means of an acoustic alarm and the respective LED indicator light.
- Volume can be set to 5 levels. The parent unit also features a LED volume indicator, which is particularly useful when the parent unit is set to a low volume.
- The baby monitor automatically switches to ECO mode when no audio is being transmitted. This reduces the transmission power to ensure power efficient operation and minimisation of radiation.
- The baby unit is powered from the power socket using a power adapter. The parent unit shall be powered using a power adapter or rechargeable batteries.

Safety instructions and important notes

- Before first use, thoroughly read the user's manual. Keep this user's manual for future use.



Attention:

This baby monitor meets all relevant standards and its use is safe when all the instructions contained in this manual are followed.

- The baby monitor serves to monitor your child when you are not in the same room and cannot supervise it directly. Nevertheless, it is important to keep in mind that your child's safety comes first and therefore this baby monitor cannot serve as a substitute for supervision by a responsible adult.
- This baby monitor is intended for home (private) use only. It is not intended for commercial purposes.
- After unpacking the baby monitor and its accessories from the packaging material, place the plastic bags in a safe location out of the reach of children. In the presence of children, plastic bags may present a suffocation hazard.
- Only use the baby monitor with the original adapters that came with it.
- Never use the baby monitor with accessories that are not approved by the manufacturer.

- Before connecting the power adapter to a power socket, make sure the voltage stated on its rating label corresponds to the voltage in the power socket. Position the power cord of the power adapter so that it will not be tripped over.
- The baby monitor may only be operated by adults.
- Children must not play with the baby monitor. Keep the baby monitor, power adapters and rechargeable batteries out of the reach of children.
- Before first using the baby monitor, acquaint yourself with its functions and before every use make sure that both the baby and parent unit are in working order and that the rechargeable batteries are not flat when they are used to power the parent unit.
- Ensure that the baby monitor and the power adapter do not come into contact with hot surfaces or sharp objects.
- Do not place the baby monitor in the vicinity of water containers or appliances that are sources of heat.
- Do not cover the baby monitor and do not place any items on it.
- Do not use the baby monitor in an excessively dusty or humid environment. Do not subject it to extreme temperature changes and electromagnetic fields.
- Do not submerge the baby monitor and its accessories in water or rinse under running water.
- Always disconnect the baby monitor from the power socket when not using it, after the batteries have been recharged and before cleaning it.
- Do not disconnect the power adapter from the power socket by pulling on the power cord. This could damage the power adapter or the power socket. Disconnect the power adapter from the power socket by pulling on the plug.
- For powering the parent unit from an internal power source, only use type Ni-MH type AAA batteries (2x 1.2 V / 550 mAh).
- When not using the baby monitor for an extended period of time, remove the batteries from the parent unit.
- Keep the batteries out of the reach of children as they may present a hazard to a child. In the event that a child swallows a battery, immediately seek medical help.
- Do not attempt to short circuit or break the battery or throw it into a fire. Do not subject the battery to direct sunlight, fire, etc.
- Do not make any alterations to the baby monitor that would change its electrical or mechanical properties.
- The baby monitor must not be operated with auxiliary amplifiers of high-frequency power or directional antennas.
- Do not use the baby monitor if it is in any way damaged or if the power adapter is damaged.
- Do not attempt to repair the baby monitor yourself. Have all repairs or adjustments performed at an authorised service centre. By tampering with the product you risk voiding your legal rights arising from unsatisfactory performance or quality warranty.
- We recommend saving the original box, packaging material, receipt and responsibility statement of the vendor or warranty card for the duration of warranty. It is appropriate to transport the baby monitor in its original box.

Description of the accessories

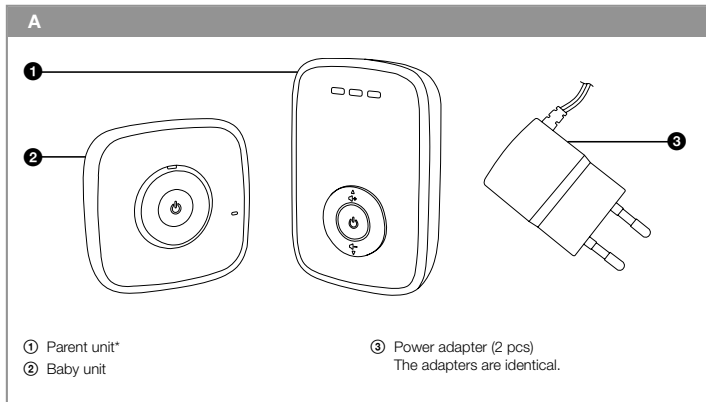

Note*:

The parent unit comes with two type AAA rechargeable batteries (2× 1.2 V / 550 mAh).

Description of the baby unit

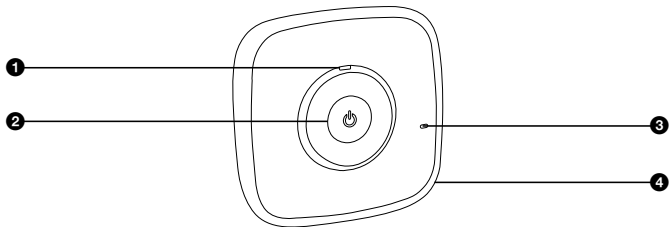
B

- ① Power On LED indicator light
- ② Button for turning the baby unit on and off
- ③ Microphone

- ④ Socket for connecting the plug on the power adapter (not shown), it is located at the rear of the baby unit.

Description of the parent unit

C

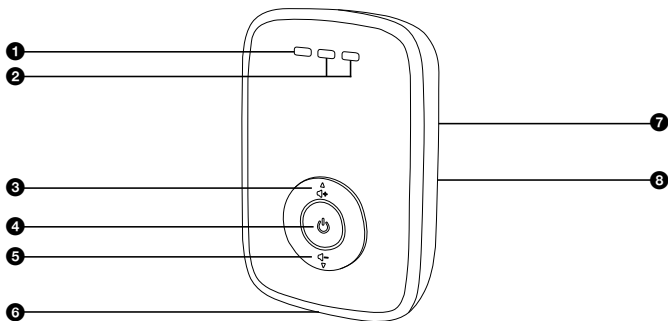

- ① Connection/On LED indicator light
- ② Volume LED indicator light
- ③ Increase volume button
- ④ Button for turning the parent unit on and off
- ⑤ Decrease volume button
- ⑥ Socket for connecting the plug on the power adapter (not shown), it is located at the bottom of the parent unit.
- ⑦ Loudspeaker (not shown), it is located at the rear of the parent unit.
- ⑧ Battery compartment (not shown), it is located at the rear of the parent unit.

Installation location of the baby unit and parent unit

1. Baby unit

- Locate the baby unit A② within reach of a power socket on an even, dry and stable surface in the room where you want to monitor your child. We recommend an elevated location (e.g. chest of drawers or a shelf) at a sufficient distance away from equipment and devices that could cause signal interference.
- The baby unit A② should be located at least 1 m away from your child to minimise the effects of electro-smog.



Attention:

Never locate the baby unit A② or the power adapter A③ in the baby's bed or within the reach of your child.

2. Parent unit

- Put the parent unit A① in the room where you will be located. When the parent unit A① is to be powered from the grid, locate it within reach of a power socket.

Power source

1. Baby unit

■ External power source and its use

- For powering the baby unit A②, use only the original power adapter A③ model number EP19A-060040WXEZ (input 6V = 400mA).
- Insert the connector of the power adapter A③ into the socket B④ that is located at the rear of the baby unit A②. Insert the plug of the power adapter A③ into a power socket.

2. Parent unit

■ External power source and its use

- For powering the parent unit, use only the original power adapter A③ model number EP19A-060040WXEZ (input 6V = 400mA).
- Insert the connector of the power adapter A③ into the socket C⑥ that is located at the bottom of the parent unit A①. Insert the plug of the power adapter A③ into a power socket.

**Attention:**

For safety reasons, the parent unit A① when powered from an external power source can only be put into operation with rechargeable batteries inserted inside.

Internal power source and its use

- For powering the parent unit from an internal power source, use the supplied Ni-MH type AAA batteries (2× 1.2 V / 550 mAh).
- From the rear of the parent unit A①, remove the cover of the battery compartment C⑧. Insert rechargeable batteries into this compartment C⑧. When inserting the batteries, make sure that you maintain the correct polarity, which is marked in the battery compartment C⑧. Close the cover.
- The rechargeable batteries must be charged for at least 16 hours before the parent unit A① can be used for the first time independently of the external power source. The batteries will start charging when the parent unit A① is connected to an external power source. You may use the parent unit A① while it is charging.

Note:

Subsequent recharging will require only approximately 10 hours.

- When you disconnect the parent unit A① from the power socket after charging it, you may use it independently of an external power source.
- Fully charged batteries will last for approximately 10 hours of operation. The operating time will depend on the battery power level and their capacity. The maximum battery capacity is achieved after they have been fully charged several times. The lifetime of the batteries depends on many factors such as charging frequency, ambient temperature at which the batteries are charged and stored, etc.
- We recommend that the batteries are charged and kept at room temperature and at least once every six months to allow them to fully discharge in the parent unit A① and subsequently recharge them fully.
- Battery operation minimises electro-smog which arises due to the effect of alternating electric and magnetic fields.
- In the event that the batteries are almost flat and there is a connection between the units A① and A②, an acoustic alarm signal will be sounded approximately every 30 seconds, indicating that the parent unit A① needs to be connected to an external power source in order for the batteries to recharge. In the event that there is no connection between the units A① and A②, this signal will be sounded approximately every 10 seconds. If you do not connect the parent unit A① to an external power source, it will turn itself off automatically after a certain time. The Power On LED indicator light C① will turn off.

Note:

The interval after which the parent unit A① automatically turns off depends on the mode in which the parent unit A① is, the battery capacity, battery age, etc.

- In the event that you are planning not to use the baby monitor for an extended period of time, take the batteries out of the parent unit A① and store them out of the reach of children.

Using the baby monitor

1. Turning the baby unit on and off

- The baby unit A② will turn on automatically when it is connected to a working power socket. This is signalled by the LED indicator light B① being lit.
- To turn off the baby unit A②, press the On/Off button B② and hold it down for approximately 2 seconds. The turned off state of the baby unit A② is signalled by the LED indicator light B① turning off.
- To turn the baby unit A② that is connected to a power socket on again, it is necessary to press the On/Off button B② and hold it down for approximately 2 seconds.
- When you have finished using it, always turn off the baby unit A② and disconnect the power adapter A③ from the power socket.

2. Turning the parent unit on and off

- The parent unit A① automatically turns on when it is connected to a working power socket or after the batteries are inserted, unless they are completely flat. When the parent unit A① is turned on, the Connection/On indicator light C① will start flashing. As soon as a connection is made with the baby unit A②, the LED indicator light C① will remain permanently lit.

**Attention:**

For safety reasons, the parent unit A① when powered from an external power source can only be put into operation with rechargeable batteries inserted inside.

- In the event that the parent unit A① was turned off manually after the batteries were inserted or after being connected to a power socket, it is necessary to press the On/Off button C④ and hold it down for approximately 2 seconds to turn it on again.
- Turn off the parent unit A① by again pressing the On/Off button C④ and holding it down for approximately 2 seconds. The turned off state of the parent unit A① is signalled by the LED indicator light B① turning off.

3. Setting the volume intensity

- Buttons C③ and C⑤ can be used to increase and decrease the volume on the parent unit A①. The volume setting is confirmed by the volume LED indicator C② turning on for a short time, and an acoustic signal will be sounded. Volume can be set to 5 levels. The maximum volume setting is indicated by both volume LED indicator lights C② being lit shortly. If the setting is outside the possible volume range, an acoustic warning will be made when button C③ or C⑤ is pressed.

General information about using the baby monitor

- Before using the baby monitor for monitoring your child, always check that both the baby and parent unit A② and A① are in working order, that there is a connection between the units and that audio is being transmitted. The connection between the units is indicated by the Connection/On LED indicator light C①.
- The sound detected by the baby unit A② is transmitted to the parent unit A①. LED indicator lights C② will inform you about audio transmission. This will be particularly useful when the parent unit A① is set to a low volume.
- In the event that there is no connection between the baby and parent unit A② and A① (the baby unit A② is turned off or out of signal range), the connection/On LED indicator light C① will flash and sound an acoustic alarm signal (beeping).
- To increase the signal range, place the baby unit A② in an elevated location as close as possible to the door or window.
- Other radio waves may interfere with the signal transmission. For this reason, do not place the baby monitor in the vicinity of appliances such as e.g. a microwave oven or WLAN devices, etc.
- The following factors may interfere with the signal or reduce its range:
 - one of the units is covered,
 - obstacles in the signal transmission direction such as furniture, walls, trees, etc.
 - weather events such as fog, rain, etc.

ECO mode

- The baby monitor automatically switches to ECO mode when no audio is being transmitted. This reduces the transmission power to minimum to ensure power efficient operation and limits unnecessarily exposing your child to radiation.

Troubleshooting

Problem	Solution
LED indicator light B① does not light up when the baby unit A② is turned on.	Check that the power adapter A③ is connected to a working power socket and that the plug on the power cord is properly inserted into socket B④.
LED indicator light C① does not start flashing/light up when the parent unit A① is turned on.	<p>Check that the power adapter A③ is connected to a working power socket and that the plug on the power cord is properly inserted into socket C⑥.</p> <p>Check whether the rechargeable batteries need to be recharged and check them for damage.</p>
The parent unit A① is sounding an alarm signal.	<p>Check that the signal range has not been exceeded.</p> <p>Check that the baby unit A② is plugged into a power socket.</p> <p>Check that the baby unit A② is turned on.</p> <p>The rechargeable batteries inside the parent unit A① may be flat or damaged. In the event that the batteries are flat, recharge them. Damaged batteries must be replaced with new ones of the same type.</p>
A high tone is coming out of the parent unit A①.	The units are located too close to each other. Move the parent unit A① farther away from the baby unit A②. The parent unit A① should be located at least 1 metre away from the baby unit A②.
Transmitted audio cannot be heard.	On the parent unit A①, set a higher volume using button C③.
The parent unit A① turns off automatically.	The rechargeable batteries are weak. Recharge them.
Weak signal, signal interference or the connection is repeatedly interrupted.	<p>If there is any equipment located in the signal transmission direction, e.g. a microwave oven, move it elsewhere or turn it off.</p> <p>Check whether there are any obstacles in the signal transmission direction, e.g. trees. Move the units so that a permanent connection is made.</p> <p>Check that the units are within the signal range.</p>

Cleaning and maintenance

- Before cleaning the baby monitor, disconnect it from the power socket. If it becomes soiled, wipe the external parts of the baby and parent units A② and A① using a cloth lightly dampened in lukewarm water. Then wipe everything so that it is thoroughly dry.
- To clean the adapters A③, use a clean, dry cloth.
- For cleaning, do not use abrasive cleaning products, solvents, thinners, etc. Never submerge the baby monitor or its power adapters A③ in water or rinse under running water.

Technical specifications

Model number	BBM 7000
Frequency broadcast band	1 880–1 900 MHz
Transmission power	20 dBm (100 mW)
Range in open space	up to 300 m
Audio transmission	one way communication
Voltage and amperage draw	6 V \pm , 400 mA
Power source	power adapter, EP19A-060040WXEZ input: 100–240 V \sim , 50/60 Hz, 200 mA, output: 6 V \pm , 400 mA
	or
	rechargeable batteries Ni-MH type AAA, 2 \times 1.2 V / 550 mAh (only the parent unit)

Value and precision.....	Unit
Manufacturer's name or trade mark, commercial registration number and address	Dongguan everest industrial Co, Ltd, No. 2 Xingyi road, Shangjiao community, ChangAn Town, 523878 Donguang Guangdong, Peoples republic of China
Model identifier	EP19A-060040WXEZ
Input voltage.....	100-240 V
Input AC frequency.....	50/60 Hz
Output voltage.....	6 V
Output current	0,4 A
Output power	2,4 W
Average active efficiency.....	73,93 %
No-load power consumption	0,042 W
Electrical shock protection class (power adapter)	II
Battery operating time	approximately 10 hours with fully charged batteries (parent unit)

Explanation of symbols used on the product, its accessories and packaging



This symbol indicates that this appliance meets all the basic requirements of EU directives related to it.



This symbol indicates that the product has protection class II.



This symbol indicates the polarity of the power cord connectors.



This symbol indicates that it is a product that may be used indoors.

LOT.

This abbreviation serves to designate the production lot number.



This symbol indicates that the requirements of directive 2011/65/EU (RoHS II) have been met for limiting the use of certain hazardous substances in electrical and electronic equipment.



This symbol on products or original documents means that used electric or electronic products must not be added to ordinary municipal waste. For proper disposal, renewal and recycling hand over these appliances to determined collection points. Alternatively, in some European Union states or other European countries you may return your appliances to the local retailer when buying an equivalent new appliance. Correct disposal of this product helps save valuable natural resources and prevents potential negative effects on the environment and human health, which could result from improper waste disposal. Ask your local authorities or collection facility for more details. In accordance with national regulations penalties may be imposed for the incorrect disposal of this type of waste.

For business entities in European Union states

If you want to dispose of electric or electronic appliances, ask your retailer or supplier for the necessary information.

Disposal in other countries outside the European Union.

This symbol is valid in the European Union. If you wish to dispose of this product, request the necessary information about the correct disposal method from the local council or from your retailer.

Batteries contain environmentally damaging substances and therefore do not belong in standard household waste. Take the batteries to an appropriate collection point, which will take care of their ecological disposal. You can obtain the contact for the nearest collection point from your town council or from your retailer.



Instructions and information about the handling of used packaging

Dispose of used packaging material at a site designated for waste in your municipality.

BAYBY hereby declares that radio device model number BBM 7000 is in compliance with directive 2019/1782/EU. A valid declaration of conformity can be found at www.bayby.com.

The Czech language is the original version of the user's manual. Changes to text and technical parameters are reserved.

Authorized service centres

Please visit our website www.bayby.com for detailed information about authorised service centres.