

Table of Contents

Introduction	2
Safety instructions and important notes	3
Description	6
Preparing for sterilisation.	7
Operation	7
Cleaning the appliance and removal of limescale deposits	8
Technical specifications	8
Explanation of symbols used on the product, its accessories and packaging	9
Instructions and information about the handling of the used packaging and product	9

Introduction

- The Bayby BBS 3010 Electric Steam Steriliser features a large capacity, sterilises 6 baby bottles of all types at the same time or 4 baby bottles with accessories within 9 minutes. Completely and very quickly eliminates bacteria using high temperature steam.
- Easy single button control. Easy and comfortable operation. Automatic shut off when sterilisation is finished.
- The specially developed inner construction prevents milk remains from flowing on to the heating plate. Elimination of soiling ensures a higher degree of completeness and hygienic cleanliness of the sterilisation process. The stainless steel heating plate eliminates the formation of limescale deposits.

Safety instructions and important notes

- Only use the steriliser in accordance with the instructions included in this user's manual. Not adhering to these instructions may result in the incorrect operation of the steriliser or its damage. Keep this user's manual for future use.
- Never submerge the base unit, power cord or power plug in water or in any other liquid.
- In the event that limescale deposits are not removed according to the user's manual, permanent damage may result.
- The appliance may be used by children up to 8 years of age and persons with limited physical, sensory or mental abilities or by persons with insufficient experience and knowledge only when under supervision or after they have been instructed about the safe use of the appliance and when they are aware of all risks associated with using the appliance. Cleaning and user maintenance must not be performed by children younger than 8 years of age and that are unsupervised. Children must not play with the steriliser.
- Clean the steriliser according to the instructions contained in chapter Cleaning the appliance and removal of limescale deposits.
- Do not preheat the appliance.
- Keep the appliance and the power cord out of children's reach.
- Before connecting the appliance to the power grid, check that the voltage specified on the appliance corresponds to the voltage in the local power grid.
- If you discover a defect on the power plug, power cord or on the appliance, stop using it.
- In the event that the power cord is damaged, it must be replaced by an authorised service centre to prevent potential hazards.
- Do not attempt to open the electric steam steriliser yourself nor perform maintenance or repairs on it.
- The appliance heats up to a high temperature during the sterilisation process and may cause burns.

- Be careful of the hot steam escaping from the openings in the lid and also of the steam released when the lid is removed.
- Steam may cause burns. Only remove the bottles accessories using the provided tongs.
- Do not touch the base unit, handles or the lid during the sterilisation process or shortly after it because these parts are very hot. Only lift the lid by the handle.
- Never move the appliance or open it while it is running or the water inside it is still hot.
- Do not place any items on to the appliance while it is in operation.
- Only use water free of additional agents.
- Do not put bleach or other chemicals into the appliance.
- Only sterilise bottles and accessories suitable for sterilisation. Before sterilisation, carefully study the manuals of the respective items and check that they are suitable for sterilisation. Do not sterilise items that are filled with water, for example pieces for teething with cooling fluid.
- If you wish to stop the appliance during the sterilisation process, disconnect it from the power socket.
- The appliance is intended exclusively for indoor use.

**Attention:**

Do not leave the steriliser without supervision when it is connected to a power socket.

- Never use any accessories or parts from other manufacturers. The use of such parts or accessories shall void the warranty.
- Do not subject the appliance to extreme heat or direct sunlight.
- Allow the appliance to fully cool down before storing or moving it.
- When the appliance is turned on, do not place items directly on to the heating element.
- Do not use the appliance if it has fallen or if you discover any type of damage. Entrust repairs to an authorised service centre.
- Always place and use the appliance on a dry, stable, level and horizontal surface.

- Do not place the appliance on a hot surface.
- Do not leave the power cord hanging over the edge of the table or countertop on which it is placed.
- After you have finished using the appliance and it has cooled down, always pour out the water that remains inside.
- Always disconnect the appliance when you have finished using it.
- Do not sterilise very small items, which could fall through the holes in the bottom of the trays A②, A⑦.
- The operation of this appliance may be affected by the conditions of the ambient environment, e.g. temperature and altitude above mean sea level.

Description

Description of the product

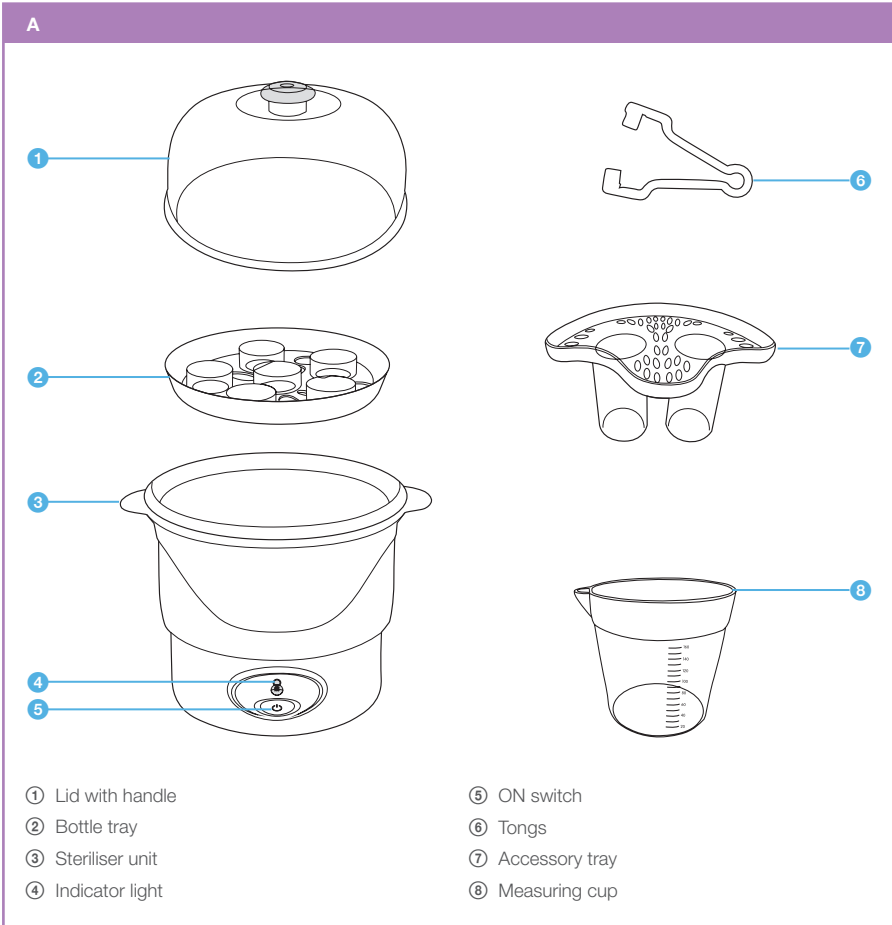

All parts, except for the stainless steel heating plate, are made from a material that does not contain BPA (Bisphenol A).

Preparing for sterilisation

- Before sterilising bottles and accessories, thoroughly wash them with a bottle brush and accessories in hot water using a detergent suitable for children, rinse thoroughly and allow to dry.

Assembling the steriliser

- The steriliser is assembled in two ways depending on the type of items that are to be sterilised.
 - It is possible to leave only the bottle tray A② at the bottom of the steriliser unit A③ and sterilise up to 6 baby bottles.
 - It is possible to leave the bottle tray A② and the accessories tray A⑦ on the bottom of the steriliser unit A③ by first inserting into the steriliser unit A③ the bottle tray A② and then into the holes in the bottle tray A② the tray for accessories A⑦ such as nipples, dummies, etc. and sterilise 4 bottles and two nipples. Place bottles into the tray A② with their bottom facing upwards and the bottle lids, nipples, screw rings and dummies into holes in the accessories tray A⑦ in a horizontal position.

Note:

Make sure that all parts intended for sterilisation have been completely disassembled. Place them into the tray with the opening facing downwards so that they do not fill up with water.

- Before turning on the steriliser, place the lid with handle A① on to the steriliser unit A③ making sure that it has properly adhered to the steriliser unit A③. Never turn on the steriliser without putting on the lid with handle A①. Now the appliance is ready for operation.

Operation



Attention:

Never use the appliance without water inside the steriliser!

- The steam that is released during the sterilisation process is hot. Keep your hands away from the appliance during the sterilisation process.
- Stand the steriliser on a horizontal and stable surface.
- Using the measuring cup A⑥, measure out exactly 90 ml of tap water and pour it directly on to the stainless steel heating plate inside the appliance. The water level should exceed the stainless steel heating part.
- Assemble the steriliser according to the instructions contained in the chapter Assembling the steriliser and insert the trays and then the items intended for sterilisation into them.
- Put on the lid A① and make sure that it has properly adhered to the steriliser unit A③.
- Insert the power plug into a power socket.
- Turn on the steriliser by pressing the ON button A⑤.
- The indicator light A④ will be lit indicating that the appliance is in operation.
- After the sterilisation process is completed, the steriliser will turn off automatically.
- Wait until the appliance cools down. Only then take off the lid using handle A①.
- Be careful, steam may come out of the steriliser.
- Remove bottles or other items from the trays using the provided tongs A⑥. Be careful, sterilised items may still be hot.

Note:

Thoroughly wash your hands before touching any sterilised items.

- Disconnect the appliance from the socket and wait until it cools down completely.
- Pour out all the water remaining in the water tank inside the steriliser unit A③ and wipe the water tank dry.

Cleaning the appliance and removal of limescale deposits

Cleaning

- After every use, disconnect the steriliser from the power socket and allow it to cool down.
- For hygiene reasons, pour out any remaining water from the steriliser unit A③.
- Clean the outer and inner side of the steriliser unit A③ using a damp cloth.



Attention:

Do not clean the steriliser, its parts or its accessories using abrasive products, chemical solvents, cleaning products, alcohol, sharp utensils or steel wool.



Attention:

Never place the steriliser directly under running water or submerge the appliance or its parts and accessories in water or other liquids!

- Never wash the steriliser in a dishwasher! The lid A①, trays A②, A⑦, tongs A⑥ and measuring cup A⑧ can be washed in warm water containing dishwashing detergent.
- After cleaning it, store the steriliser in a clean dry location.

Removing limescale deposits

- When using the steriliser, small stains may appear on the heating element in the steriliser unit A③. These are accumulated limescale deposits. The harder the water, the faster limescale deposits will form.
- Disconnect the steriliser from the power socket and allow it to cool down.
- It is recommended to remove limescale deposits from the appliance every 4 weeks to ensure further effective operation of the appliance.
- Mix 100 ml of white vinegar with 100 ml of hot water and pour this solution into the steriliser. Allow this solution to act for approximately 30 minutes in the steriliser unit A③ and then pour it out.
- Never turn on the appliance while the water and vinegar solution is in the steriliser unit A③.
- After emptying out the steriliser, repeatedly clean the outer and inner side of the bottle warmer using a cloth. In the event that despite this limescale deposits continue to appear, repeat the limescale removal procedure.

Technical specifications

Model number	BBS 3010
Voltage and power input of the appliance	230V ~ 50 Hz, 440 W
Protection class against injury by electrical shock	Protection class I.
Operating conditions	Ambient temperature: 7°C to 37°C

Explanation of symbols used on the product, its accessories and packaging



This symbol indicates "Important notice".



This symbol indicates that prior to using the product, the user should read the user's manual.



This symbol indicates that this appliance meets all the basic requirements of EU directives related to it.



This symbol serves to designate the production lot number.



This symbol indicates that a fee has been paid to an organisation performing recollection and utilisation of the packaging waste.



This symbol indicates the material from which the packaging is made.



This symbol on products or original documents means that used electric or electronic products must not be added to ordinary municipal waste. For proper disposal, renewal and recycling hand over these appliances to determined collection points. Alternatively, in some European Union states or other European countries you may return your appliances to the local retailer when buying an equivalent new appliance. Correct disposal of this product helps save valuable natural resources and prevents potential negative effects on the environment and human health, which could result from improper waste disposal. Ask your local authorities or collection facility for more details. In accordance with national regulations penalties may be imposed for the incorrect disposal of this type of waste.

For business entities in European Union states

If you want to dispose of electric or electronic appliances, ask your retailer or supplier for the necessary information.

Disposal in other countries outside the European Union.

This symbol is valid in the European Union. If you wish to dispose of this product, request the necessary information about the correct disposal method from the local council or from your retailer.

Instructions and information about the handling of the used packaging and product

Dispose of used packaging material at a site designated for waste in your municipality.

At the end of its service life, do not throw the appliance out with ordinary municipal waste, rather take it to a recycling facility. In this way you will help protect the environment.

The Czech language is the original version of the user's manual. Changes to text and technical parameters are reserved.