

Table of Contents

Introduction	2
Safety instructions and important notes	3
Description	7
Operation	8
Cleaning the appliance and removal of limescale deposits	10
Technical specifications	11
Explanation of symbols used on the product, its accessories and packaging	12
Instructions and information about the handling of used packaging	13

Introduction

- The multifunction Bayby BBW 2000 Baby Bottle Warmer makes it possible to easily warm up baby bottles and baby food jars within a few minutes or sterilise baby feeding accessories.
- It quickly warms up the contents of baby bottles and is easy to use.
- It sterilises accessories such as baby bottle nipples, dummies or other baby feeding accessories.
- It has a function for warming up baby food jars, e.g. purées, porridge and other foods cooked in steam.

Safety instructions and important notes

- Only use the feeding bottle warmer in accordance with the instructions included in this user's manual. Not adhering to these instructions may result in the incorrect operation of the bottle warmer or its damage. Keep this user's manual for future use.
- Only use the appliance indoors and do not expose it or its accessories to direct sunlight.
- Keep this appliance and the power cord out of reach of children that are younger than 8 years of age.
- Do not submerge the power cord, plug or the appliance in water or in any other liquid.
- Do not leave the power cord in the vicinity of hot surfaces.
- Only connect the appliance to a grounded power socket. Always check that the plug is properly inserted into the power socket.
- Before connecting the appliance, check that the voltage specified on the bottom part of the appliance corresponds to the voltage in the local power grid.
- If it is necessary to use an extension cord, check that the power cord is grounded with a nominal value of at least 10 amperes.

- Do not use the appliance if the power plug, power cord or the appliance itself is damaged. If the power cord is damaged, have it replaced at an authorised service centre to avoid a possibly dangerous situation.
- Do not place the appliance on a hot gas or electric stove or a hot oven or in their vicinity.
- The appliance may be used by children up to 8 years of age and persons with limited physical, sensory or mental abilities or by persons with insufficient experience and knowledge only when under supervision or after they have been instructed about the safe use of the appliance and when they are aware of all risks associated with using the appliance. Cleaning and user maintenance must not be performed by children younger than than 8 years of age and that are unsupervised. Children must not play with the Baby Bottle and Food Warmer.
- Clean the Baby Bottle and Food Warmer according to the instructions contained in chapter Cleaning the appliance and removal of limescale deposits.
- Do not preheat the appliance.
- Always place a fully assembled baby bottle into the Baby Bottle and Food Warmer and only then pour in the water. Make certain that you pour water into the bottle warmer before turning it on.

- Hot water may cause serious scalding. So be very careful when there is hot water inside the bottle warmer.
- Accessible surfaces of the appliance may heat up during operation.
- Do not move the appliance if it contains hot water.
- As soon as the food or milk reaches the required temperature, remove the bottle or container from the bottle warmer. If you leave the food or milk in the bottle warmer, its temperature will rise.
- Before you start feeding a child, always check the temperature of the food.



Attention:

Do not leave the bottle warmer without supervision when it is connected to a power socket.

- When not using the appliance, disconnect it from the power socket.
- Before cleaning the appliance, allow it to cool down.
- Follow the instructions for removing limescale deposits to prevent irreparable damage.

- Do not attempt to open or repair the appliance yourself. Have all repairs or adjustments performed at an authorised service centre. By tampering with the appliance you risk voiding your legal rights arising from unsatisfactory performance or quality warranty.
- We recommend saving the original box, packaging material, receipt and responsibility statement of the vendor or warranty card for the duration of warranty. It is appropriate to move the bottle warmer in its original box.

Description

Description of the product

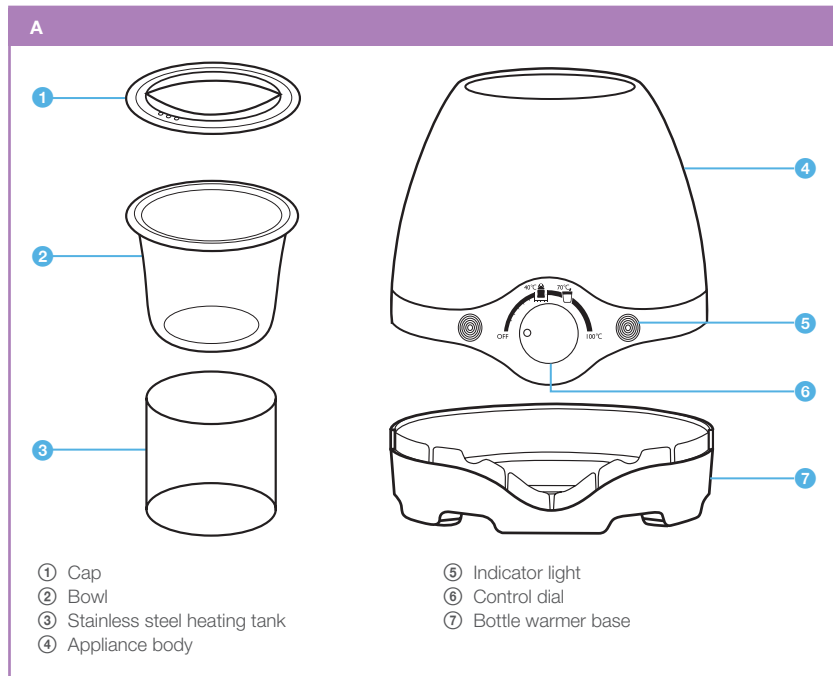

- All parts, except for the stainless steel heating tank, are made from a material that does not contain BPA (Bisphenol A).

Operation



Attention:

Never use the bottle warmer without water in the heating tank!

- Stand the bottle warmer on a horizontal and stable surface.
- The steam that is released during the warming up process is hot. Keep your hands away during the warming up process.

Warming up feeding bottles

- Pour 90 ml of water into the heating tank A③.
- Place the baby bottle into the heating tank A③.
- Never allow water to rise above the neck of the bottle or to spill over the edge of the bottle warmer.
- Check that the control dial A⑥ is in the "OFF" position (turned off) and plug the bottle warmer into a power socket.
- Select a heating method by turning the control dial A⑥ to the right to the "baby bottle 40 °C" symbol. This is the expected water temperature around the bottle. This is not the food temperature.
- The indicator light A⑤ signals that the bottle warmer is running.
- During the warming up process, the light will turn on and then turn off once the water around the bottle is heated to the maximum temperature.
- After reaching 40°C, the water temperature is maintained at the same level until the appliance is turned off by turning control dial A⑥ to the left towards the "OFF" symbol (turned off).
- Always test the food once it reaches the desired temperature, immediately remove it from the bottle warmer.
- Shake the baby food or milk after taking it out of the bottle warmer. Check the temperature of the food or milk by dripping a little on to your wrist.

Heating up baby food

- Pour 150 ml of water into the heating tank A③.
- Place the bowl A② with 90–150 ml of food into the heating tank A③.

- Place the cap A① down on to the bowl containing the food.
- Check that the control dial A⑥ is in the "OFF" position (turned off) and plug the bottle warmer into a power socket.
- Select a heating method by turning the control dial A⑥ to the right to the "bowl 70 °C" symbol. This is the expected water temperature around the bottle. This is not the food temperature.
- The indicator light A⑤ signals that the bottle warmer is running.
- During the warming up process, the light will turn on and then turn off once the water around the bottle is heated to the maximum temperature.
- After reaching 70 °C, the water temperature is maintained at the same level until the appliance is turned off by turning control dial A⑥ to the left towards the "OFF" symbol (turned off).
- Always test the food once it reaches the desired temperature, immediately remove it from the bottle warmer.
- Stir the baby food or milk after taking it out of the bottle warmer.

Sterilisation

- Pour 180ml of water into the heating tank A③.
- Place the accessories that you wish to sterilise, such as baby bottle nipples, dummies or other baby feeding accessories directly into the heating tank A③.
- Place the cap A① down on to the bottle warmer.
- Select a heating method by turning the control dial A⑥ to the right to the "100 °C" symbol.
- The indicator light A⑤ signals that the bottle warmer is running.
- During the sterilisation process, the light will turn on and then turn off once the water is heated to the maximum temperature of 100 °C.
- After reaching 100 °C, the water temperature is maintained at the same level until the appliance is turned off by turning control dial A⑥ to the left towards the "OFF" symbol (turned off).
- Allow the accessories to be sterilised for approx. 5 minutes. Then turn off the appliance by turning the control dial A⑥ to the left towards the "OFF" symbol (turned off).

Cleaning the appliance and removal of limescale deposits

Cleaning

- After every use, disconnect the bottle warmer from the power socket and allow it to cool down.
- For hygiene reasons, pour the water out of the bottle warmer.
- Clean the outer and inner side of the bottle warmer using a damp cloth.



Attention:

Do not clean the bottle warmer, its parts or its accessories using abrasive products, chemical solvents, cleaning products, alcohol or sharp utensils.

Note:

If you use the bottle warmer to heat baby food, check that there are no spilled baby food remains inside it.



Attention:

Never place the bottle warmer directly under running water or submerge the appliance or its parts and accessories in water or other liquids!

- Never wash the bottle warmer in a dishwasher!
- You may clean the cap A① and the bowl A② using a sponge or cloth dipped in soapy water or you can wash it in a dishwasher if you place them in the top dishwasher rack.

Removing limescale deposits

- Disconnect the bottle warmer from the power socket and allow it to cool down.
- It is recommended to remove limescale deposits from the bottle warmer every 4 weeks to ensure further effective operation of the appliance.

- Mix 100 ml of white vinegar with 100 ml of hot water and pour this solution into the bottle warmer. Allow this solution to act for approximately
- 30 minutes in the heating tank A③ and then pour it out.
- Never turn on the bottle warmer while the water and vinegar solution is in the heating tank A③.
- After emptying out the bottle warmer, repeatedly clean the outer and inner side of the bottle warmer using a cloth. In the event that despite this limescale deposits continue to appear, repeat the limescale removal procedure.

Technical specifications

Model number BBW 2000

Voltage and power input of the appliance 230V ~ 50 Hz, 300 W

Protection class against injury by electrical shock Protection class I.

Operating conditions Ambient temperature: 7 °C to 37 °C

Explanation of symbols used on the product, its accessories and packaging



This symbol indicates "Important notice".



This symbol indicates that prior to using the product, the user should read the user's manual.



This symbol indicates that this appliance meets all the basic requirements of EU directives related to it.



This symbol serves to designate the production lot number.



This symbol indicates that a fee has been paid to an organisation performing recollection and utilisation of the packaging waste.



This symbol indicates the material from which the packaging is made.



This symbol on products or original documents means that used electric or electronic products must not be added to ordinary municipal waste. For proper disposal, renewal and recycling hand over these appliances to determined collection points. Alternatively, in some European Union states or other European countries you may return your appliances to the local retailer when buying an equivalent new appliance. Correct disposal of this product helps save valuable natural resources and prevents potential negative effects on the environment and human health, which could result from improper waste disposal. Ask your local authorities or collection facility for more details. In accordance with national regulations penalties may be imposed for the incorrect disposal of this type of waste.

For business entities in European Union states

If you want to dispose of electric or electronic appliances, ask your retailer or supplier for the necessary information.

Disposal in other countries outside the European Union.

This symbol is valid in the European Union. If you wish to dispose of this product, request the necessary information about the correct disposal method from the local council or from your retailer.

Instructions and information about the handling of used packaging

Dispose of used packaging material at a site designated for waste in your municipality.

The Czech language is the original version of the user's manual. Changes to text and technical parameters are reserved.